



BARRIER WASHER EXTRACTORS

MED-16 / 22 ET2

EASY TOUCH 2



7" touch screen easy to use and fully programmable ET2, display on dirty side
Connection USB. PC software free of charge for programming, traceability, data analysis...
Videos on display (instructions...)
37 languages
8 dosing signals as standard

OUTSTANDING FEATURES



Automatic positioning of drum
2 water inlets
WET CLEANING, traceability as standard
Dual heating (electric - steam) model available
G FACTOR 350

EFFICIENCY



Intelligent consumption, automatic adjustment and
Optimal loading, manual adjustment of water levels and detergents according to the load
Ready for water recovery tanks : AQUABAC
High G factor : reduced residual moisture, reduced drying time
Water savings: 3 configurable levels of savings

CONNECTIVITY



Remote technical service
Management of laundry

ERGONOMICS



Huge loading and unloading doors opening
Easy drum opening by push button
Loading height (670 mm from door bottom)

MAINTENANCE



Electric elements on left side, mechanical ones on right side, connections on the top (protected from detergents and water splashes)
Central drain as standard
Technical menu : statistics, alarms, autotest, data recovery for technicians and maintenance

OTHERS



2 opposed doors
Grey skinplate outer casing.
Stainless steel AISI 304 top panel, vat and drum
Electronic control of imbalance with frequency inverter
Electric, steam or dual heating
CE approved



OPTIONS

- Second 7" screen on clean side
- Automatic weighing system on feet
- 6 extra dosing signals
- Printer
- Low steam pressure
- Third water inlet
- Double drain
- Titration valve
- Side drain valve
- 4 compartments detergent box kit
- Drum motor brake
- UPS protection kit in case of power failure (only with brake option)
- Stainless steel AISI 304 outer casing
- Plinth for loading height at 850 mm (door base)
- Stainless steel sanitary frame
- End of cycle light alarm
- Marine voltage 440V/60Hz/III without Neutral (electric models)



Intertek



Intertek

TECHNICAL DATA	UNIT.	MED-16 ET2	MED-22 ET2		
DRUM					
Capacity 1:9 / 1:10	Kg	18 / 16	24 / 22		
Volume	l	158	220		
Diameter	mm	633	633		
Depth	mm	500	700		
No of drum compartment	No	1	1		
GENERAL DETAILS					
Washing / spin speed	r.p.m.	45 / 1000	45 / 1000		
G Factor	-	350	350		
Dynamic force	KN	5,5 ±1,12	6,25 ±1,54		
Dynamic force frequency	Hz	15,4	15,4		
Sound level	dB	<70	<70		
Double drain	-	OPT	OPT		
Weighing system	-	OPT	OPT		
DRUM					
Height door bottom	mm	670	670		
Drum opening dimensions	mm	400 x 315	400 x 315		
Vat opening dimensions	mm	455 x 415	455 x 415		
POWER					
Motor	kW	2,2	2,2		
Electric heating	kW	12	18		
Total electric power (elec mod)	kW	14,2	20,2		
Total electric power (steam mod)	kW	2,2	2,2		
CONNECTIONS		ELECTRIC / DUAL	STEAM	ELECTRIC / DUAL	STEAM
Tension 230V - I + N + T	N° x mm2 / A	-	3 x 1,5 / 6A	-	3 x 1,5 / 6A
Tension 230V - III + T	N° x mm2 / A	4 x 10 / 40A	-	4 x 10 / 50A	-
Tension 400V - III + N + T	N° x mm2 / A	5 x 6 / 25A	-	5 x 6 / 32A	-
steam inlet (steam mod)	Inch	3/4"		3/4"	
Max. steam consumption (steam models)	Kg/h	9		12	
Water inlet	Inch	3/4"		3/4"	
Water pressure	Kgs/cm ²	3-5		3-5	
Max. water consumption*	Lit/h	144		198	
Drain	Inch	3"		3"	
Drain flow	Lit/min	160		160	
DIMENSIONS / PACKING DIMENSIONS					
Net width / Gross width	mm	984 / 1.072		1.184 / 1.262	
Net depth / Gross depth	mm	914 / 1.102		914 / 1.102	
Net height / Gross height	mm	1.398 / 1.530		1.398 / 1.530	
Net weight / Gross weight	kg	438 / 459		471 / 494	
Volume	m ³	1,25 / 1,81		1,51 / 2,13	

* Program N°2, load 100%

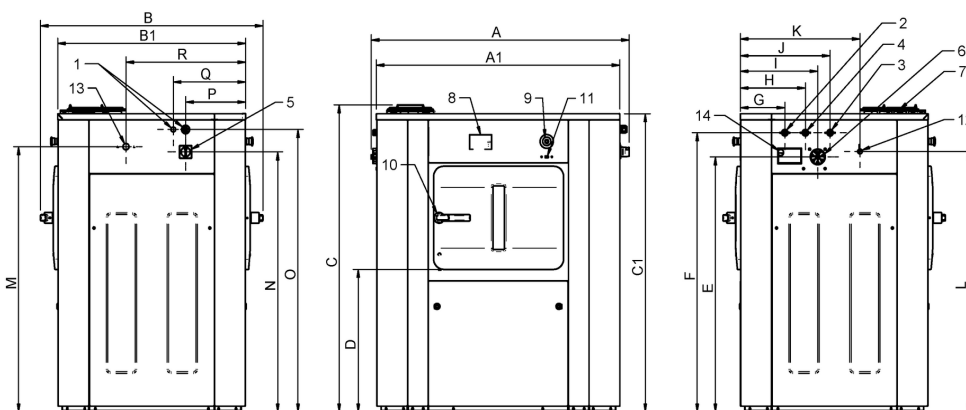

- 1 ELECTRICAL CONNEXION
- 2 HOT WATER
- 3 COLD WATER
- 4 SOFT WATER
- 5 MAIN SWITCH
- 6 LIQUID PRODUCTS INLET
- 7 DETERGENT BOX (OPTION)
- 8 CONTROL PANEL
- 9 EMERGENCY STOP
- 10 DOOR OPENING
- 11 USB PORT
- 12 DOSING PUMPS CONNEXION
- 13 STEAM INLET
- 14 EXHAUST

	A	B	C	A1	B1	C1	D	E	F	G	H	I	J	K	L	M	N	O	P	Q	R
MED-16	1054	1082	1426	984	914	1385	661	1184	1296	217	317	377	437	582	1209	1231	1207	1311	292	352	582
MED-22	1254	1082	1426	1184	914	1385	661	1184	1296	217	317	377	437	582	1209	1231	1207	1311	292	352	582