



R2D25/100-120/140/200 WALL IRONERS Ø 250 mm



ELECTRONIC PROGRAMMER

Simple and user friendly: digital screen, precise control of temperature
Preset ironing speeds, not adjustable



FEATURES

Large roll contact area with the linen
Automatic roll lifting control by photocell detection
Two available models:
Standard: roll with cotton polyester coating
Nomex: roll with Nomex coating



ROBUSTNESS

Nomex coating: resistant to high temperatures
Panels in grey skinplate and stainless steel
Wooden feeding board
New kinematics: better reliability
Industrial componets; more durable



EFFICIENCY

Acoustic comfort : 55 dB
Minimum space requirement: space saving, suitable for small spaces
Ideal for processing small quantity of flat linen in facilities like restaurants, guest rooms, hostels...



MAINTENANCE

Easy installation : requires only an electrical connection
Easy access on both sides for maintenance
Quick and easy dismantling of bearings



OTHERS

Front feeding and return
Roll ø 250 mm
Working widths: 1.400 and 2.000 mm
Electric heating
CE certification

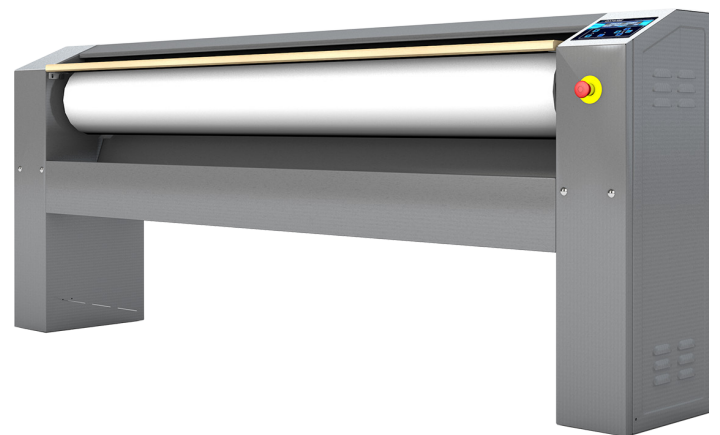

OPTIONS

- Pedal control kit (instead of photocell)
- Marine tension 440V III 60 Hz without N
- Tension 230V III 50-60 Hz

TECHNICAL DATA	UNIT.	R2D25/100	R2D25/120	R2D25/140	R2D25/200
GENERAL DATA					
Theoretical production*	Kg/h	25	27	30	35
Ø Roll	mm	250	250	250	250
Working width	mm	1.000	1.200	1.400	2.000
Ironing speed	m/min	4,2	4,2	4,2	4,2
Electronic programmer	-	Yes	Yes	Yes	Yes
Bed lifting	-	By photocell	By photocell	By photocell	By photocell
POWER					
Heating power	kW	4,95	6	7	12
Roll motor power	kW	0,18	0,18	0,18	0,18
Total electric power	kW	5,13	6,18	7,18	12,18
CONNECTIONS		ELECTRIC	ELECTRIC	ELECTRIC	ELECTRIC
Tension 230V - I + N + T	N°x mm²/A	3 x 6 / 25A	3 x 6 / 32A	3 x 40 / 30A	N/A
Tension 230V - III + T	N°x mm²/A	4 x 2,5 / 16A	4 x 4 / 20A	4 x 4 / 20A	4 x 6 / 32A
Tension 400V - III + N + T	N°x mm²/A	5 x 2,5 / 10A	5 x 2,5 / 10A	5 x 2,5 / 16A	5 x 4 / 20A
OVERALL DIMENSIONS / PACKING DIMENSIONS					
Net / gross width	mm	1.462 / 1.490	1.662 / 1.690	1.862 / 1.890	2.462 / 2.490
Net / gross depth	mm	484 / 540	484 / 540	484 / 540	484 / 540
Net / gross height	mm	985 / 1.130	985 / 1.130	985 / 1.130	985 / 1.130
Net / gross weight	kg	114 / 124	124 / 134	134 / 154	164 / 184
Volume	m3	0,69 / 0,91	0,79 / 1,03	0,89 / 1,15	1,17 / 1,51
OTHERS					
Noise level	dB	55	55	55	55

*20-25% Theoretical production

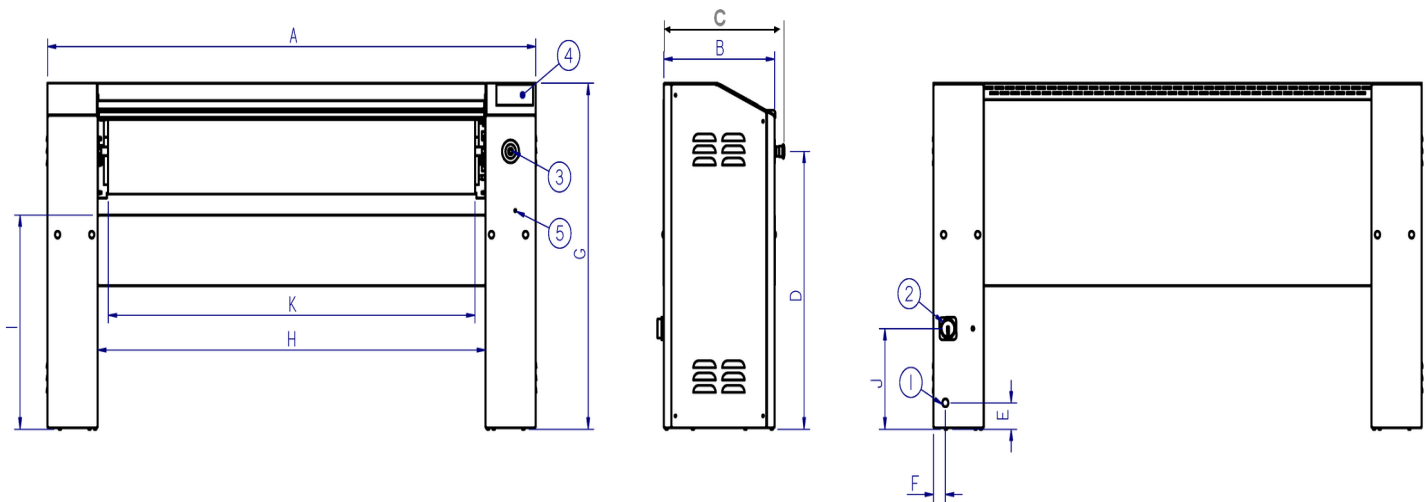

- 01. Electrical connection
- 02. Main switch
- 03. Emergency stop
- 04. Control panel
- 05. access to inverter maintenance

	A	B	C	D	E	F	G	H	I	J	K
R2D25/100	1.462	423	484	791	75	45	985	1.079	610	287	998
R2D25/120	1.662	423	484	791	75	45	985	1.279	610	287	1.198
R2D25/140	1.862	423	484	791	75	45	985	1.479	610	287	1.398
R2D25/200	2.462	423	484	791	75	45	985	2.079	610	287	1.998

